

## Safety Precautions

1. **Do not** attempt to disassemble the device.
2. There are no user-serviceable parts inside.
3. **Do not expose** or operate the device to rain or moisture.
4. **Do not clean the sensor** with strong chemicals or acids.
5. **Do not operate** the device beyond its operating temperature & operating humidity.
6. **Do not** place the device beyond heating elements.
7. **Do not** place magnet near to device while operating.
8. **Do not** operate the device beyond its operating Voltage.
9. **Do not drop** the device or submit it to sudden impact or mechanical stresses.
10. **Do not remove** the device label or warranty seal.
11. **Do not Scratch** on display & camera

## What's in the Box?



Device

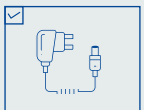

Power Charger

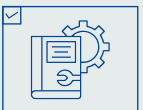

User Manual &amp; Installation Guide



Shoulder Belt

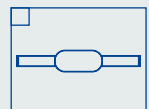

Hand Strap Belt

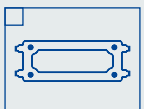

Wall Mount Plate

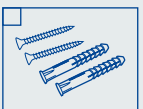

Screw &amp; Wall Plug

## Warranty Terms

1. The warranty is confined to the first purchaser of the product only and is not transferable.
2. Repairs under warranty period shall be carried out by the company authorized personnel only. The details of service centers/support required are available at the company website [www.mantratec.com/Support](http://www.mantratec.com/Support) or in the centralized helpline (+917949068000).
3. The Offsite Warranty of the product excluding battery & charger shall be of twelve (12) months ("Warranty Period") commencing from the date of our Tax Invoice. The Offsite Warranty of the charger & battery shall be of six (6) months commencing from the date of our Tax Invoice. For support, please contact RMA Support at <https://servico.mantratecapp.com/MasterForms/RMARequestTerms.aspx>. The warranty does not cover the damages caused due to negligence, wrong usage, mishandling, physical damage, etc. Any variation in terms and conditions of Warranty clause is indicated in our Tax Invoice. Original Tax Invoice is compulsory for claiming any warranty.
4. The company does not undertake responsibility for the quality of software being used by the purchaser.
5. The company shall not be liable for any direct, indirect or consequential loss, damage, cost or expense of any kind, whether arising from tort, breach of contract or howsoever, including without limitation loss of profits or of contracts, loss of operation time and loss of goodwill or anticipated savings.
6. Maximum Liability of company under or in connection with the product, for any reason and on any basis whatsoever, is limited to fifty percent (50 %) of the total amount of the product.
7. In the event of repairs of any part/s of the unit, this warranty will thereafter continue and remain in force only for the unexpired period of the warranty. The period for repair and in transit whether under the warranty or otherwise shall not be excluded from the warranty period.
8. In case of any damage to the product/misuse detected by the authorized service center personnel, the warranty conditions are not applicable and repairs will be done subject to availability of parts and on a chargeable basis only.
9. In the event of any unforeseen circumstance, and spares not being available, the company's prevailing depreciation rules will be binding on the purchaser to accept as a commercial solution in lieu of repairs.
10. The warranty does not cover the cost of transportation of the system from the place of installation to the Service Center.

**Rights and Obligations** : User guarantees that the product will not be used in any way that violates the law or legal rights of any third party (including but not limited to Intellectual Property Rights, privacy rights, and portrait rights). In case of violation, the user shall bear the legal liabilities and other responsibilities arising therefrom.



RMA Support

## Consumer Notices

**FCC NOTICE** : This equipment has been tested and found to comply with the limits for a Class B digital device, pursuant to Part 15 of the FCC Rules. These limits are designed to provide reasonable protection against harmful interference in a residential installation. This equipment generates, uses, & can radiate radio frequency energy and, if not installed and used in accordance with the instructions, may cause harmful interference to radio communications. However, there is no guarantee that interference will not occur in a particular installation. If this equipment does cause harmful interference to radio or television reception, which can be determined by turning the equipment off and on, the user is encouraged to try to correct the interference by one or more of the following measures: (1) Reorient or relocate the receiving antenna; (2) Increase the separation between the equipment and receiver; (3) Connect the equipment into an outlet on a circuit different from that to which the receiver is connected; or (4) Consult the dealer or an experienced radio/TV technician for help. Changes or modifications not expressly approved by the party responsible for compliance to Part 15 of the FCC Rules could void the user's authority to operate the equipment.

**CE NOTICE** : This equipment has been tested and found to comply with the limits for a Class B or Class 2 digital device, pursuant to EN 55032 & EN 55035 Rules. These limits are designed to provide reasonable protection against harmful interference when the equipment is operated in a commercial environment. This equipment generates, uses, and can radiate radio frequency energy and, if not installed and used in accordance with the instruction manual, may cause harmful interference to radio communications. Operation of this equipment in a residential area is likely to cause harmful interference in which case the user will be required to correct the interference at the expense of the user. Changes or modifications not expressly approved by the party responsible for compliance to EN 55032 & EN 55035 Rules could void the user's authority to operate the equipment. This Class B digital apparatus meets all requirements of the Canadian Interference-Causing Equipment Regulations.

# MOXA7

## PORTABLE BIOMETRIC RUGGED TERMINAL FOR IDENTIFICATION



### Quick Installation Guide

Mantra Softech is a Global Hi-Tech Manufacturer of Biometric Products and Solutions. We Offer a Wide Range of Products in Biometric and RFID Industry.

**MANTRA**  
Innovation that counts

- ◆ **Download Drivers & SDK**  
<http://download.mantratecapp.com>
- ◆ **Support / Service Email**  
<http://servico.mantratecapp.com>  
[servico@mantratec.com](mailto:servico@mantratec.com)
- ◆ **On Call Support & Service**  
Cell: 079-49068000

## Product Introduction



## Handheld Application



## Mounting the Device onto the Wall

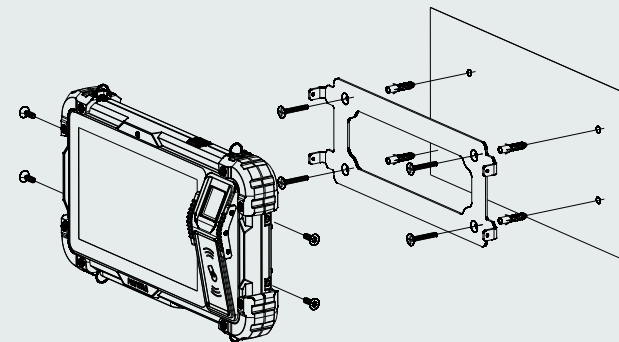

- Step 1.** Take the wall mount bracket from the kit and place it 4-5 feet up from the floor line.
- Step 2.** Mark and drill four holes in the wall.
- Step 3.** Get four wall anchors from the kit and hammer them into the drilled holes.
- Step 4.** Fix the wall mount bracket on the wall by the screws.
- Step 5.** Place the device onto the mounting bracket and tighten the screws both side end.

## Operating & Handling Instructions

- Installing the Micro-SIM Card**  
Insert the SIM card into the respective cardslot, and ensure good contact.
- Connecting to AC Power**  
Use power adapter which is given with device.
- Power On**  
Press the power button and hold for 3 seconds to turn on the device. Before turning on, make sure the battery is charged and is properly installed in the battery holder.
- Power Off**  
When the device is on, press the power button for 3 seconds, and select power Off in the popup menu to turn off the device.
- Sleep**  
When you do not use the device temporarily, you can press the power button to set to sleep mode.
- Wake Up**  
If the device is in the slept state, you can press the power button to wake up the device.
- Fingerprint Scanner**  
Clean the glass portion of the sensor with the cleaning cloth provided or use special optical cloth in order to clean the glass area.
- Fingerprint Sensor Active**  
When the LED in the sensor is On then the sensor is active to capture the image.
- Handheld Application**  
Use Hand strap belt & shoulder belt
- Wall Mount Application**  
Use wall mount plate

